

CAUTION: Max 5 Amps 12/24VDC (low voltage). Use only with Class 2 power supply. Indoor dry location use.

ATTENTION: Utiliser seulement avec la classe 2 bloc d'alimentation.

For use only with LED World's type A (IP20) 12VDC and 24VDC 10mm wide LED Flex Strips. Not to be used with Type B or C (Strips that have covers or coatings).

Important Note: Check the Polarity and make sure that connector contact points are directly over (and centered) the LED Flex Strip connector pads. Do not connect LED strips at soldered contact points.

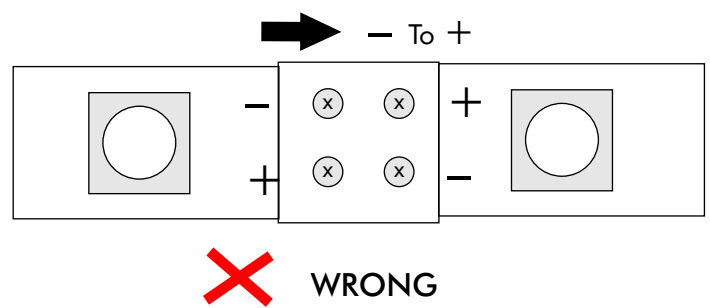
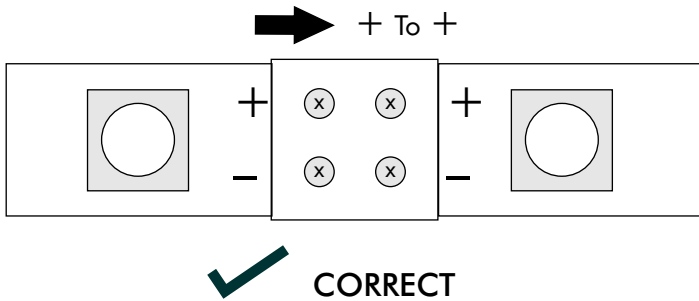

OPTIONAL ACCESSORIES

STEP 1

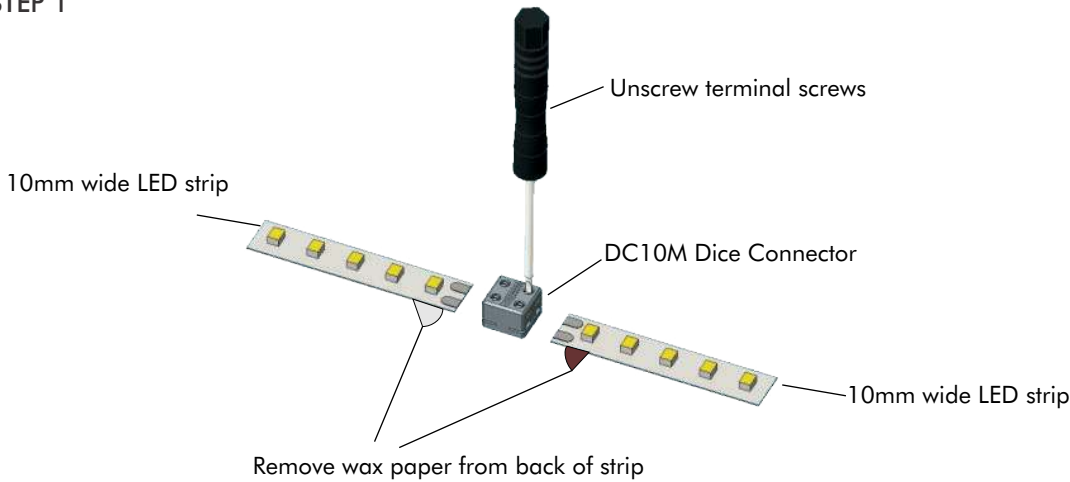

STEP 2

